

UNLESS OTHERWISE SPECIFIED, ALL DIMENSIONS ARE IN METRIC.

TO 1 DECIMAL PLACES ±.3
TO 2 DECIMAL PLACES ±.12
AS ANGLES ± 1/2°

ISSUE

B

DATE

02/04/00

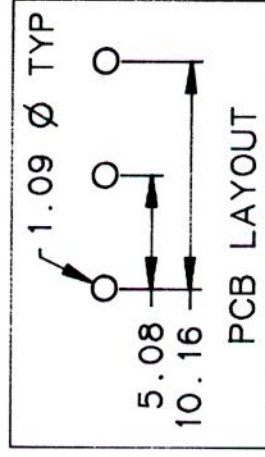
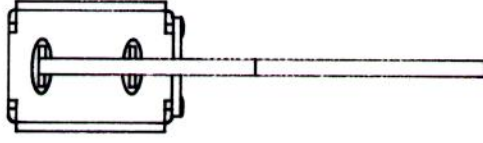
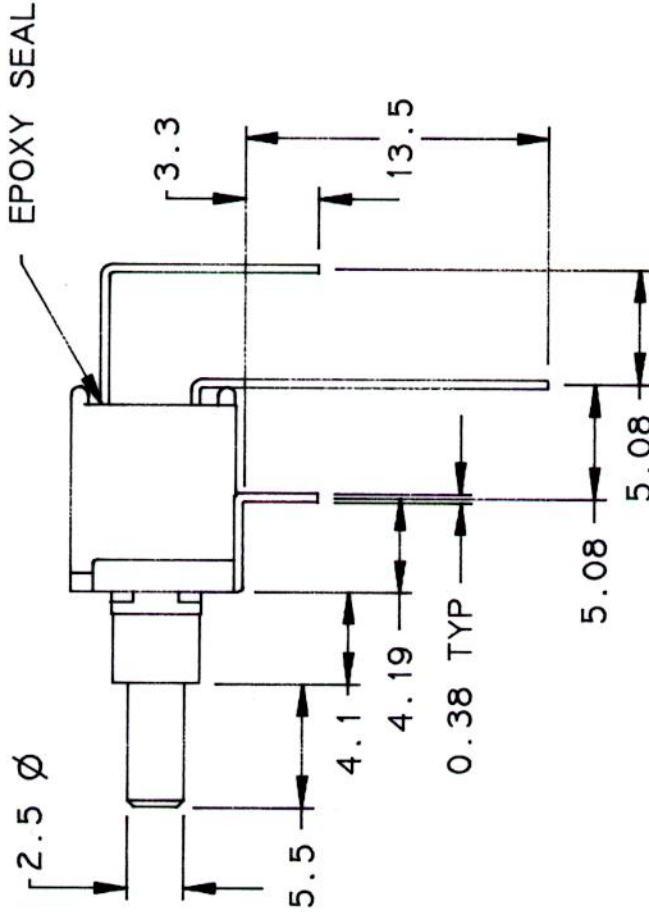
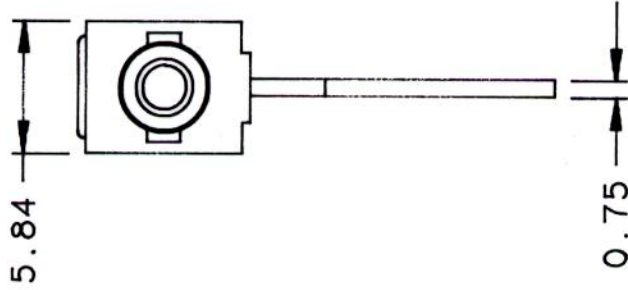

- NOTES:
1. FIRST 'X' DENOTES ACTUATOR LENGTH: 'E' FOR EXTENDED (SHOWN) OR 'F' FOR FLUSH
 2. 2ND 'X' DENOTES PLATING: 'Q' FOR SILVER OR 'R' FOR GOLD



SENIOR INDUSTRIES, INC.

TITLE: PUSHBUTTON SWITCH

PART NO:

SSSP-TS21B-XCX

DATE: 10/01/97

DRAWN: H V

CHKD:

SCALE: 3/1

SHEET:

1 OF 2

UNLESS OTHERWISE SPECIFIED, ALL DIMENSIONS ARE IN METRIC.

TO 1 DECIMAL PLACE ±
TO 2 DECIMAL PLACES ±
AS ANGLES ±

ISSUE

DATE

B

02/04/00

SPECIFICATIONS

ELECTRICAL

CONTACT RATING:

SILVER 3A @ 120VAC, 28VDC

1A @ 250VAC

GOLD 0.4VA MAX. @ 20 V MAX. (AC OR DC)

CONTACT RESISTANCE: 20 MILLIOHMS MAX.

INSULATION RESISTANCE: 1000 MEGOHMS MIN. @ 500 VDC

DIELECTRIC STRENGTH: 1000 VRMS FOR ONE MINUTE

MECHANICAL

LIFE: 50,000 CYCLES

ENVIRONMENTAL

OPERATING TEMPERATURE: -30° C TO +85° C

MATERIAL

HOUSING: NYLON, UL94V-0

PLUNGER: POLYESTER, UL94V-0

FRAME: BRASS OR STEEL, TIN PLATED

CONTACT: COPPER ALLOY, SILVER OR GOLD PLATED



**SENIOR
INDUSTRIES, INC.**

TITLE:

PUSHBUTTON SWITCH

PART NO:

SSSP-TS21B-XCX

DATE:

10/01/97

DRAWN:

H V

CHKD:

42

SCALE:

SHEET:

2 OF 2