

1

2

3

4

COMPONENT SPECIFICATION

USE OR REPRODUCTION OF THIS DRAWING FOR THE PURPOSE OF MANUFACTURING THIS ARTICLE OR ANY ARTICLES SHOWN FOR ANY PURPOSE IS STRICTLY PROHIBITED WITHOUT WRITTEN PERMISSION FROM SENIOR INDUSTRIES, INC.

A

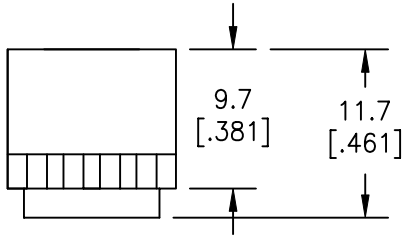

POSITIONS	1	2	3
A	11.7 [0.461]	21.7 [0.854]	31.8 [1.252]

B

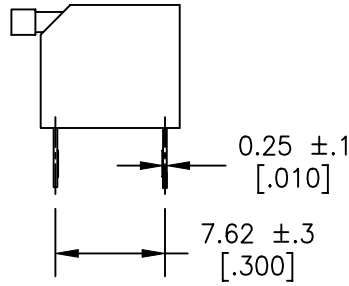
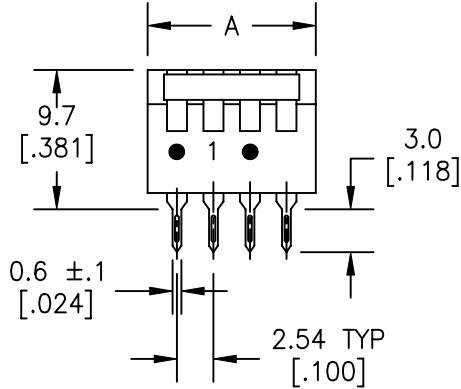

SRPG601SC SHOWN

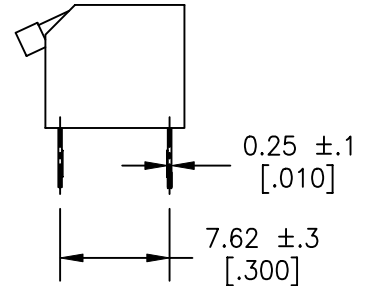

SRPG601S1C SHOWN

C

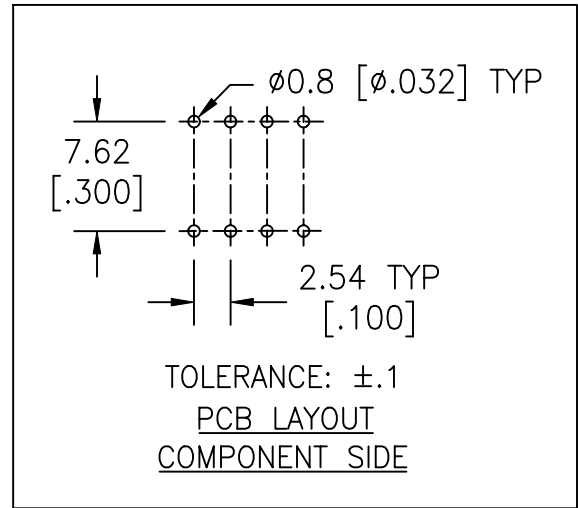
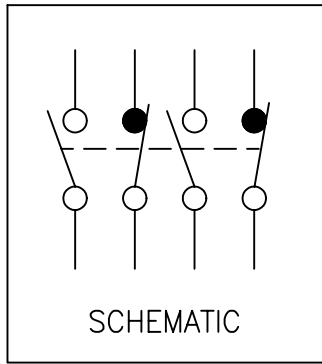

D

E

DESIGNED:			SYM.	DATE:	DESCRIPTION OF REVISIONS:	DRAWN	APPD.
DRAWN:	GAT	09/26/06		09.26.06	NEW	GAT	JF
CHECKED:	GAT	09/26/06		. . .			
APPROVED:	JF	09/27/06		. . .			

3RD ANGLE		UNIT:	mm[IN]	SCALE:	1:1	REV.	A
-----------	--	-------	--------	--------	-----	------	---



TOLERANCE:		PART NO:
TO 1 DECIMAL PLACE:	±.3	SRPG6XXXX
TO 2 DECIMAL PLACES:	±.2	TITLE:
AS ANGLES:	±1/2°	PIANO DIP SWITCH
SHEET:		1 OF 3

1

2

3

4

COMPONENT SPECIFICATION

USE OR REPRODUCTION OF THIS DRAWING FOR THE PURPOSE OF MANUFACTURING THIS ARTICLE OR ANY ARTICLES SHOWN FOR ANY PURPOSE IS STRICTLY PROHIBITED WITHOUT WRITTEN PERMISSION FROM SENIOR INDUSTRIES, INC.

A

SPECIFICATIONS

ELECTRICAL:

ACTION: DPDT
 CONTACT RATING:
 SWITCHING: 25mA @ 24 VDC
 NON-SWITCHING: 100mA @ 50 VDC
 CONTACT RESISTANCE (INITIAL): 50 MILLIOHMS MAX.
 INSULATION RESISTANCE: 1000 MEGOHMS MIN. AT 100 VDC
 DIELECTRIC STRENGTH: 500 VDC MIN. FOR 1 MINUTE

B

MECHANICAL:

LIFE: 1000 CYCLES MIN.
 OPERATION FORCE: 800g MAX.

ENVIRONMENTAL:

OPERATING TEMPERATURE: -25°C TO 70°C
 STORAGE TEMPERATURE: -40°C TO +85°C
 PART SHALL WITHSTAND WAVE SOLDERING TEMPERATURE OF 260° FOR 5 SECONDS.

C

MATERIAL:

HOUSING: GLASS FILLED POLYESTER, UL94V-0
 TERMINALS: PHOSPHOR BRONZE, 0.25t
 PLATING: CONTACT AREA - GOLD PLATING OVER NICKEL
 TERMINATION AREA - GOLD OVER NICKEL

PART NUMBER BUILDER:

MODEL	TYPE	POSITIONS	ACTUATOR	SILKSCREEN	HOUSING COLOR
SRPG	<input type="checkbox"/>	<input type="checkbox"/>	<input type="checkbox"/>	<input type="checkbox"/>	<input type="checkbox"/>
	6=DPDT	01 02 03	S =STANDARD (TOP SIDE 'OFF') S1 =STANDARD (TOP SIDE 'ON') ST =STANDARD (TOP SIDE 'OFF') & TOP TAPE SEALED ST1=STANDARD (TOP SIDE 'ON') & TOP TAPE SEALED	A (TOP SIDE 'OFF') B (TOP SIDE 'ON') C	BLANK -BLUE 3 -BLACK

D

NOTE: CASE IS BLUE/BLACK WITH WHITE SWITCH ACTUATORS.

E

DESIGNED:			SYM.	DATE:	DESCRIPTION OF REVISIONS:	DRAWN	APPD.
DRAWN:	GAT	09/26/06		09.26.06	NEW	GAT	JF
CHECKED:	GAT	09/26/06		. . .			
APPROVED:	JF	09/27/06		. . .			

3RD ANGLE		UNIT:	mm[IN]	SCALE:	REV.	A
-----------	--	-------	--------	--------	------	---

	TOLERANCE:	PART NO:
	TO 1 DECIMAL PLACE: ±	SRPG6XXXX
	TO 2 DECIMAL PLACES: ±	TITLE:
	AS ANGLES: ± °	PIANO DIP SWITCH
SHEET:	2 OF 3	

1

2

3

4

COMPONENT SPECIFICATION

USE OR REPRODUCTION OF THIS DRAWING FOR THE PURPOSE OF MANUFACTURING THIS ARTICLE OR ANY ARTICLES SHOWN FOR ANY PURPOSE IS STRICTLY PROHIBITED WITHOUT WRITTEN PERMISSION FROM SENIOR INDUSTRIES, INC.

A

SILKSCREEN OPTIONS

B

A (TOP SIDE 'OFF')

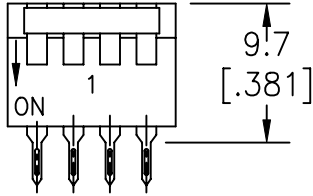

C

B (TOP SIDE 'ON')

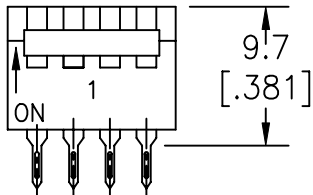

D

C

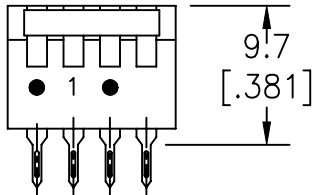

E

DESIGNED:			SYM.	DATE:	DESCRIPTION OF REVISIONS:	DRAWN	APPD.
DRAWN:	GAT	09/26/06		09.26.06	NEW	GAT	JF
CHECKED:	GAT	09/26/06		. . .			
APPROVED:	JF	09/27/06		. . .			

3RD ANGLE		UNIT:	mm[IN]	SCALE:	1:1	REV.	A
-----------	--	-------	--------	--------	-----	------	---



TOLERANCE:	PART NO:
TO 1 DECIMAL PLACE: ±.3	SRPG6XXXX
TO 2 DECIMAL PLACES: ±.2	TITLE:
AS ANGLES: ±1/2°	PIANO DIP SWITCH
SHEET:	3 OF 3